



SPECIFICATION

Electrical Rating : 20A 125VAC/16A 250VAC(UL)  
16A 250VAC(VDE)  
Mechanical life: Over 30000 cycles  
Electrical life: Over 10000 cycles  
Contact resistance: <20mΩ  
Insulation resistance: >1000MΩ  
High voltage resistance: >1500V 1 min.  
Ambient temperature: Terminal side -20 to +85°C  
Actuating side -20 to +55°C  
Storage temperature: -30 to +80°C Max  
Atmospheric humidity: Max.85%  
Actuating force: 4~8N(depends on different switch function)  
Flammability: UL94 V-2  
Temperature rise at the terminal: Max 30°C (UL1054)  
Solder ability of terminal: Max 350°C ,3s

MATERIALS

Housing: Nylon 66  
Rocker: PC & PA66  
Contacts: Silver Alloy  
Terminal: Brass Silver Plated  
Lamp: Neon Lamp,Tungsten Lamp  
Spring: SWP,SUS  
Movable Arm: Brass Silver Plated



HOW TO ORDER

X2-R5 1 5 K K E T 0 F A

Series	Switch Function	Rating	Housing Color	Actuator Color	Marking	Terminal Type	Lamp Voltage	Safety Approval
Series			W White K Black		See option of marking (See Page 231)	0 Without Lamp 1 125V AC 2 250V AC 3 12 VDC 4 24 VDC		F 4 Safety Approvals E None Approval
1 ON-OFF 2 ON-ON 3 ON-OFF-ON 4 ON-(ON) 5 OFF-(ON) 6 (ON)-OFF-(ON) 7 ON-(OFF) 8 ON-OFF-(ON) 9 ON-OFF (With Lamp)		5 16A 250VAC 20A 125VAC	W White K Black R Red	Y Yellow(III.) M Green(III.) D Red(III.) F Blue(III.)				Quick Connect Tab

OPTIONS OF SWITCH FUNCTION / DIMENSION

Item NO	POLES &THROWS	Rocker position ( ):Momentary		
		Left	Center	Right
X2-R51	DPST	ON	None	OFF
X2-R52	DPDT	ON	None	ON
X2-R53	DPDT	ON	OFF	ON
X2-R54	DPDT	ON	None	(ON)
X2-R55	DPST	OFF	None	(ON)
X2-R56	DPDT	(ON)	OFF	(ON)
X2-R57	DPST	ON	None	(OFF)
X2-R58	DPDT	ON	OFF	(ON)
X2-R59	DPST (WITHLAMP)	ON	None	OFF

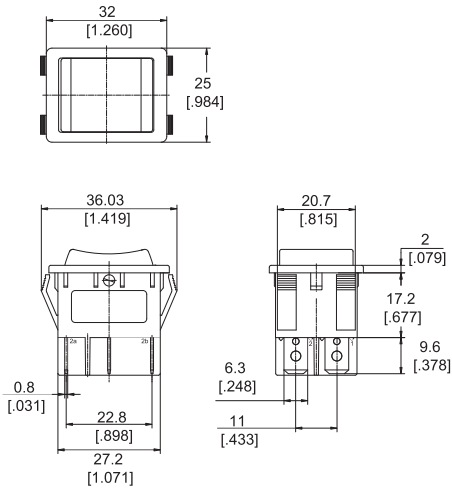

PANEL CUT OUT

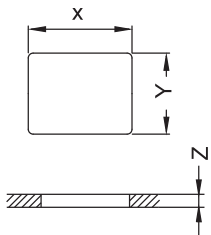

Z	Y	X
0.70~1.25	22.20~22.30	30.0~30.20
1.25~2.00	22.20~22.30	30.2~30.40
2.00~3.00	22.20~22.30	30.6~30.80

CIRCUITS FOR SWITCH WITH LAMP

For circuit of 250V AC or 125V AC  
For circuit of 24V DC or 12V DC

